

Souled Out Show Band is an 8 piece act.

Booking can be reached at booking@sosb.band

Management can be reached at management@sosb.band

Electrical requirements:

FOUR (4) separate 20 Amp Circuits

Backline requirements:

None Required

Stage Risers:

ONE (1) Drum Riser

Minimum Stage footprint:

COVERED area 16'x20'

Stage Snake Split:

Provided by Venue if using Venue FOH.

FOH and Lighting:

Provided by venue unless arranged in advance.

Band provided FOH provides coverage for audience of 300 or less on a single level.

Stage Input List:

1	Mark B	VOX - Wireless Mic (band provided)	IEM	Stage Right - Downstage
2	Krystn C	VOX - Wireless Mic (band provided)	IEM	Stage Center - Downstage
3	Steve P	VOX - Wireless Mic (band provided)	IEM	Stage Right - Downstage
4	Jim M	VOX - Wireless Mic (band provided)	IEM	Stage Right - Downstage
5	Marc S	VOX - (Mic needed)	IEM	Stage Left - Downstage
6	Ray D	VOX - (Mic needed)	IEM	Stage Left - Upstage
7	Alto Sax (Jim M)	Wireless Mic (band provided)		
8	Tenor Sax (Mark B)	Wireless Mic (band provided)		
9	Bari Sax (Mark B)	Wireless Mic (band provided)		
10	Trumpet (Steve P)	Wireless Mic (band provided)		
11	Guitar (Marc S)	Headrush DI (built in) MONO	IEM	
12	Upper Keys (Ray D)	DI needed - MONO	IEM	
13	Lower Keys	DI needed - MONO		
14	Bass Gtr (Geoff B)	Amp - DI Needed	Wedge	Stage Right - Upstage
15	Kick (Russ M)	Audix D6 (band provided)	Wedge	Stage Center - Upstage (riser if poss)
16	Snare	Shure Beta57 (band provided)		
17	Hat	Shure SM81 (band provided)		
18	Rack 1	Shure Beta98 (band provided)		
19	Rack 2	Shure Beta98 (band provided)		
20	Floor	Senn E604 (band provided)		
21	OH	Shure SM81 (band provided)		

SOSB STAGE PLOT

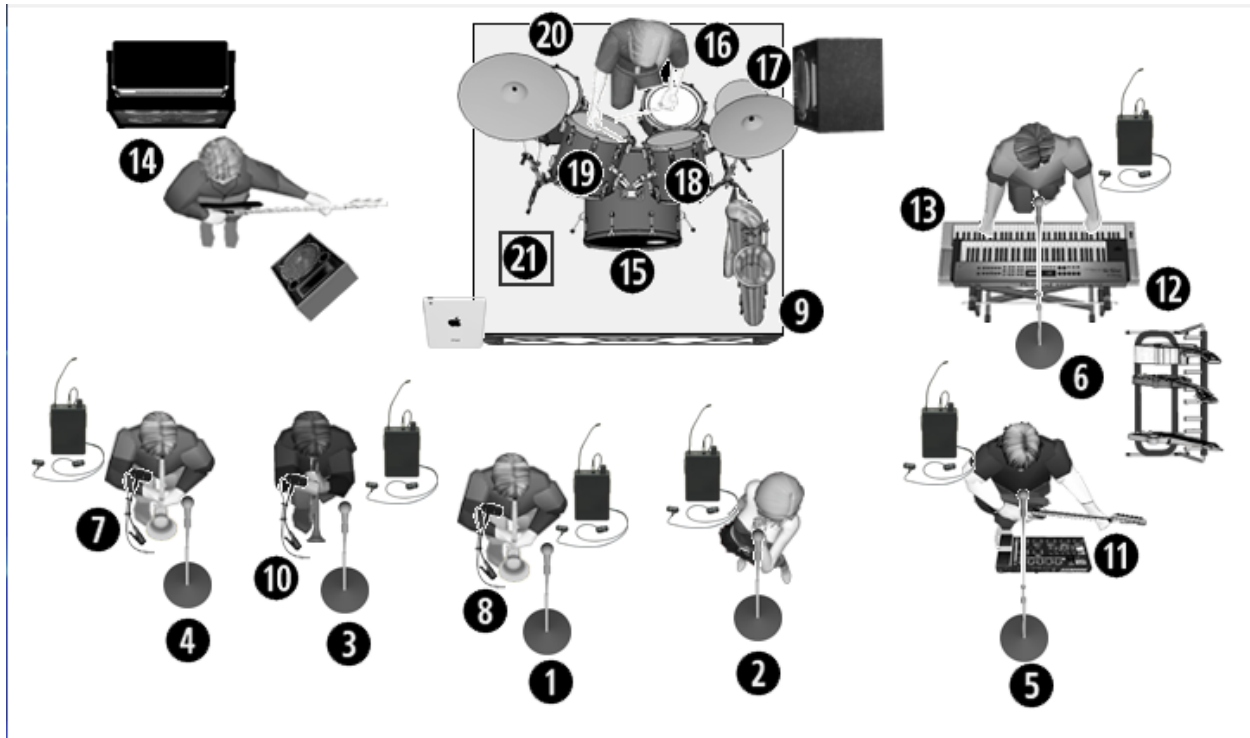

- 1. Mark B Vox
- 2. Krystn Vox
- 3. Steve Vox
- 4. Jim Vox
- 5. Marc S Vox
- 6. Ray Vox
- 7. Alto Sax (Jim)
- 8. Tenor Sax (Mark B)
- 9. Bari Sax (Mark B)
- 10. Trumpet (Steve)

- 11. Guitar (Marc)
- 12. Upper Keys (Ray)
- 13. Lower Keys (Ray)
- 14. Bass (Geoff)
- 15. Kick (Russ)
- 16. Snare
- 17. Hats
- 18. Rack 1
- 19. Rack 2
- 20. Floor

- 21. OH
- 22. (open)
- 23. (open)
- 24. (open)
- 25.